

# 南安市2024-71-02地块（核减后）征地勘测界定图

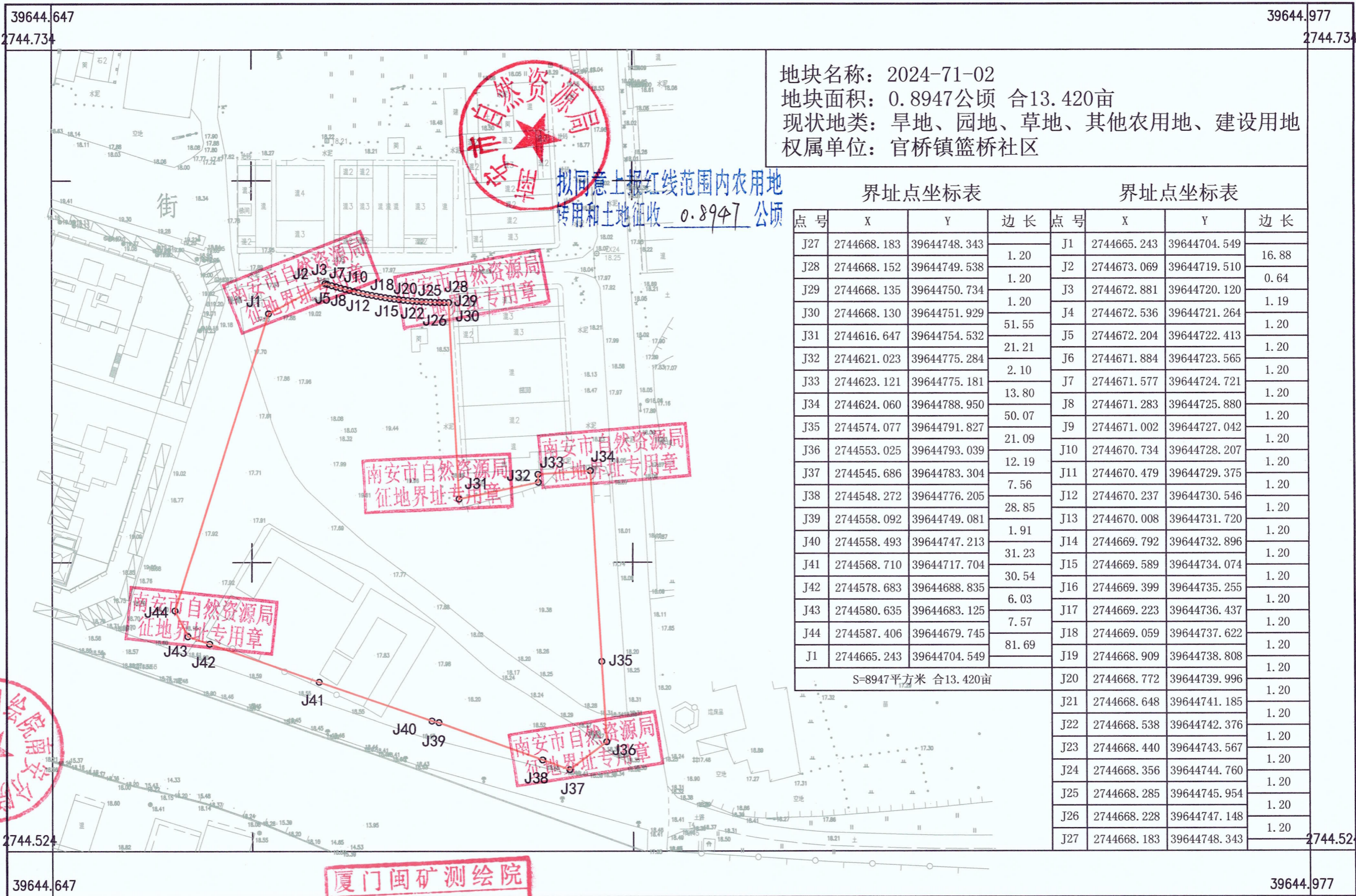

地块名称: 2024-71-02  
 地块面积: 0.8947公顷 合13.420亩  
 现状地类: 旱地、园地、草地、其他农用地、建设用地  
 权属单位: 官桥镇篮桥社区

拟同意上报红线范围内农用地  
转用和土地征收 0.8947 公顷

界址点坐标表

界址点坐标表

点号	X	Y	边长	点号	X	Y	边长
J27	2744668.183	39644748.343		J1	2744665.243	39644704.549	16.88
J28	2744668.152	39644749.538	1.20	J2	2744673.069	39644719.510	0.64
J29	2744668.135	39644750.734	1.20	J3	2744672.881	39644720.120	1.19
J30	2744668.130	39644751.929	1.20	J4	2744672.536	39644721.264	1.20
J31	2744616.647	39644754.532	51.55	J5	2744672.204	39644722.413	1.20
J32	2744621.023	39644775.284	21.21	J6	2744671.884	39644723.565	1.20
J33	2744623.121	39644775.181	2.10	J7	2744671.577	39644724.721	1.20
J34	2744624.060	39644788.950	13.80	J8	2744671.283	39644725.880	1.20
J35	2744574.077	39644791.827	50.07	J9	2744671.002	39644727.042	1.20
J36	2744553.025	39644793.039	21.09	J10	2744670.734	39644728.207	1.20
J37	2744545.686	39644783.304	12.19	J11	2744670.479	39644729.375	1.20
J38	2744548.272	39644776.205	7.56	J12	2744670.237	39644730.546	1.20
J39	2744558.092	39644749.081	28.85	J13	2744670.008	39644731.720	1.20
J40	2744558.493	39644747.213	1.91	J14	2744669.792	39644732.896	1.20
J41	2744568.710	39644717.704	31.23	J15	2744669.589	39644734.074	1.20
J42	2744578.683	39644688.835	30.54	J16	2744669.399	39644735.255	1.20
J43	2744580.635	39644683.125	6.03	J17	2744669.223	39644736.437	1.20
J44	2744587.406	39644679.745	7.57	J18	2744669.059	39644737.622	1.20
J1	2744665.243	39644704.549	81.69	J19	2744668.909	39644738.808	1.20
S=8947平方米 合13.420亩				J20	2744668.772	39644739.996	1.20
				J21	2744668.648	39644741.185	1.20
				J22	2744668.538	39644742.376	1.20
				J23	2744668.440	39644743.567	1.20
				J24	2744668.356	39644744.760	1.20
				J25	2744668.285	39644745.954	1.20
				J26	2744668.228	39644747.148	1.20
				J27	2744668.183	39644748.343	1.20

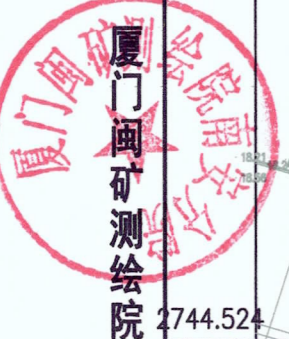

厦门闽矿测绘院  
 测绘资质: 甲级(2)  
 证书编号: 甲测资字35100129  
 发证机关: 福建省自然资源厅

1:1000

测量员: 林永泉  
 绘图员: 傅燕玲  
 检查员: 陈志平

2024年8月数字化制图。  
 2000国家大地坐标系: 中央子午线117度。  
 1985国家高程基准, 等高距为1米。  
 2007年版图式。