

南安市2024-4-1地块征地勘测界定图

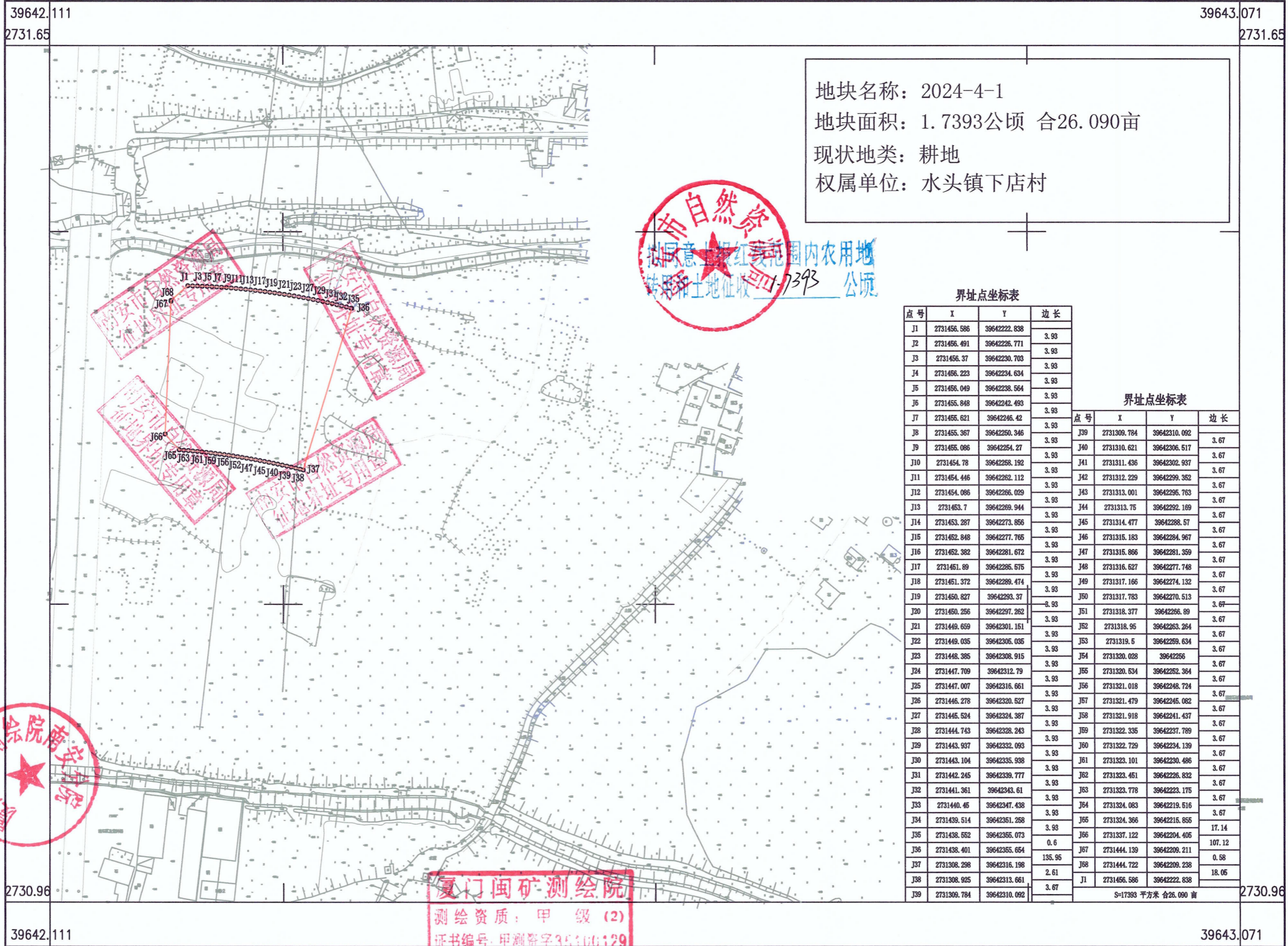

地块名称: 2024-4-1
 地块面积: 1.7393公顷 合26.090亩
 现状地类: 耕地
 权属单位: 水头镇下店村

市自然资源局
 批同意在红线范围内农用地
 转用和征收 1.7393 公顷

界址点坐标表

点号	X	Y	边长
J1	2731456.586	3964222.838	3.93
J2	2731456.491	3964226.771	3.93
J3	2731456.37	3964230.703	3.93
J4	2731456.223	3964234.634	3.93
J5	2731456.049	3964238.564	3.93
J6	2731455.848	3964242.493	3.93
J7	2731455.621	3964246.42	3.93
J8	2731455.367	3964250.346	3.93
J9	2731455.086	3964254.27	3.93
J10	2731454.78	3964258.192	3.93
J11	2731454.446	3964262.112	3.93
J12	2731454.086	3964266.029	3.93
J13	2731453.7	3964269.944	3.93
J14	2731453.287	3964273.856	3.93
J15	2731452.848	3964277.765	3.93
J16	2731452.382	3964281.672	3.93
J17	2731451.89	3964285.575	3.93
J18	2731451.372	3964289.474	3.93
J19	2731450.827	3964293.37	3.93
J20	2731450.256	3964297.262	3.93
J21	2731449.659	3964301.151	3.93
J22	2731449.035	3964305.035	3.93
J23	2731448.385	3964308.915	3.93
J24	2731447.709	3964312.79	3.93
J25	2731447.007	3964316.661	3.93
J26	2731446.278	3964320.527	3.93
J27	2731445.524	3964324.387	3.93
J28	2731444.743	3964328.243	3.93
J29	2731443.937	3964332.093	3.93
J30	2731443.104	3964335.938	3.93
J31	2731442.245	3964339.777	3.93
J32	2731441.361	3964343.61	3.93
J33	2731440.45	3964347.438	3.93
J34	2731439.514	3964351.258	3.93
J35	2731438.552	3964355.073	0.6
J36	2731438.401	3964358.654	135.95
J37	2731308.298	39642316.198	2.61
J38	2731308.925	39642313.661	3.67
J39	2731309.784	39642310.092	3.67

界址点坐标表

点号	X	Y	边长
J39	2731309.784	39642310.092	3.67
J40	2731310.621	39642306.517	3.67
J41	2731311.436	39642302.937	3.67
J42	2731312.229	39642299.352	3.67
J43	2731313.001	39642295.763	3.67
J44	2731313.75	39642292.169	3.67
J45	2731314.477	39642288.57	3.67
J46	2731315.183	39642284.967	3.67
J47	2731315.866	39642281.359	3.67
J48	2731316.527	39642277.748	3.67
J49	2731317.166	39642274.132	3.67
J50	2731317.783	39642270.513	3.67
J51	2731318.377	39642266.89	3.67
J52	2731318.95	39642263.264	3.67
J53	2731319.5	39642259.634	3.67
J54	2731320.028	39642256	3.67
J55	2731320.534	39642252.364	3.67
J56	2731321.018	39642248.724	3.67
J57	2731321.479	39642245.082	3.67
J58	2731321.918	39642241.437	3.67
J59	2731322.335	39642237.789	3.67
J60	2731322.729	39642234.139	3.67
J61	2731323.101	39642230.486	3.67
J62	2731323.451	39642226.832	3.67
J63	2731323.778	39642223.175	3.67
J64	2731324.083	39642219.516	3.67
J65	2731324.366	39642215.855	17.14
J66	2731337.122	39642204.405	107.12
J67	2731444.139	39642209.211	0.58
J68	2731444.722	39642209.238	18.05
J1	2731456.586	3964222.838	3.67

S=17393 平方米 合26.090 亩

厦门闽矿测绘院

厦门闽矿测绘院
 测绘资质: 甲级(2)
 证书编号: 甲测资字35110129
 发证机关: 福建省自然资源厅

1:3000

测量员: 傅森华
 绘图员: 陈学毅
 检查员: 程少强

2024年1月数字化制图
 2000国家大地坐标系;中央子午线117度
 1985国家高程基准;等高距为1米
 2007年版图式